

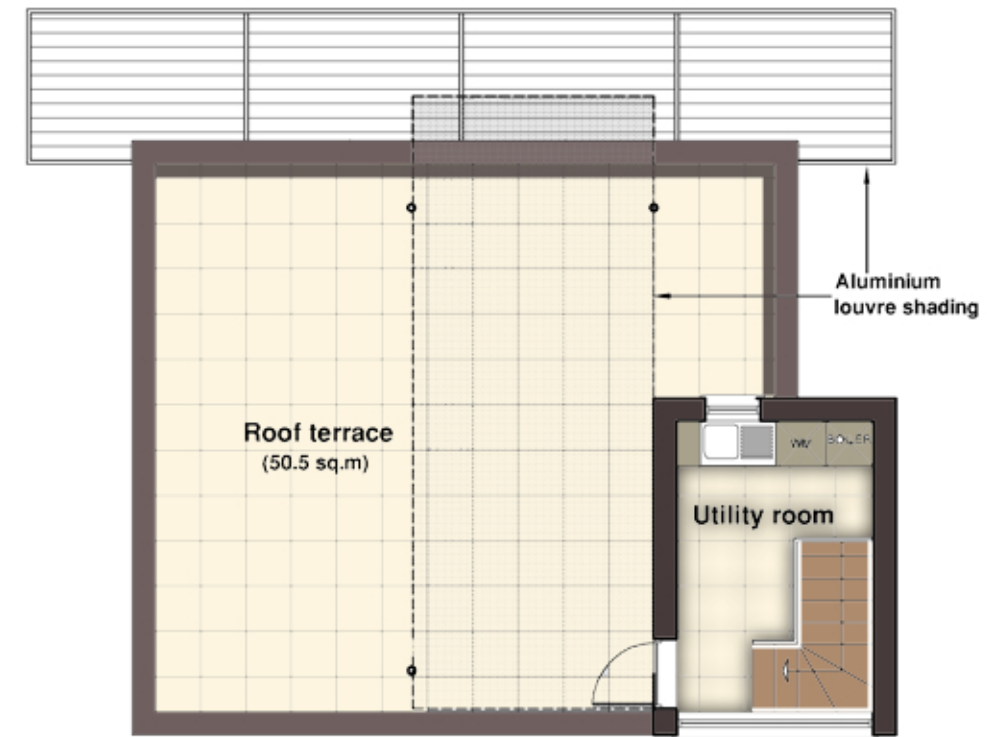

**GROUND FLOOR PLAN**

Plot area 600-1000sq.m (6458-10763sq.f)



**ROOF PLAN**

Roof terrace area 50.5 sq.m (544 sq.f)



**FIRST FLOOR PLAN**

Balcony area 31 sq.m (333sq.f)

**\* FLOOR AREA 149.5 SQM PLUS 31 SQM BALCONY TERRACE AND 50.5 SQM ROOF TERRACE**

**LAYOUT OPTION A REV A 1:100@A3**



**\*PROPOSED INTERNAL FLOOR AREAS GREATER THAN 150SQ.M SUBJECT TO SEPERATE AGREEMENT**